



Amos Jacques Road, Bedworth, CV12 8BS

**SHELDON  
BOSLEY  
KNIGHT**

LAND AND  
PROPERTY  
PROFESSIONALS



# Property Description

\*\*\*FOUR BED, EXTENDED SEMI\*\*\*

We are delighted to present this four bedroom, extended, semi-detached home on Amos Jacques Road. Situated in a sought after area in Bedworth, close by to local amenities, schools, and the town centre. With great transport links to the A444 this home offers the peace and quiet of being away from main roads whilst still being conveniently positioned.

Briefly comprising; Entrance hall, spacious lounge, extended kitchen/dining space, four bedrooms with the master granting en-suite facilities, and family bathroom. The exterior provides ample off road parking to the front, and a rear garden with artificial grass and decking area.

Complete with gas fired central heating, double glazed windows, a double storey side extension, and an excellent finish throughout, this home is a must-see. Call us now for more information! EPC rating B & Council tax band B







## Key Features

- Extended Semi-Detached Home
- Four bedrooms
- Master En-Suite
- Beautiful Open-Plan Ground Floor Layout
- Off Road Parking
- Close By To Local Amenities
- Sought After Location
- COUNCIL TAX BAND B & EPC RATING B

**£280,000**





## Ground Floor

Approx. 44.1 sq. metres (475.0 sq. feet)

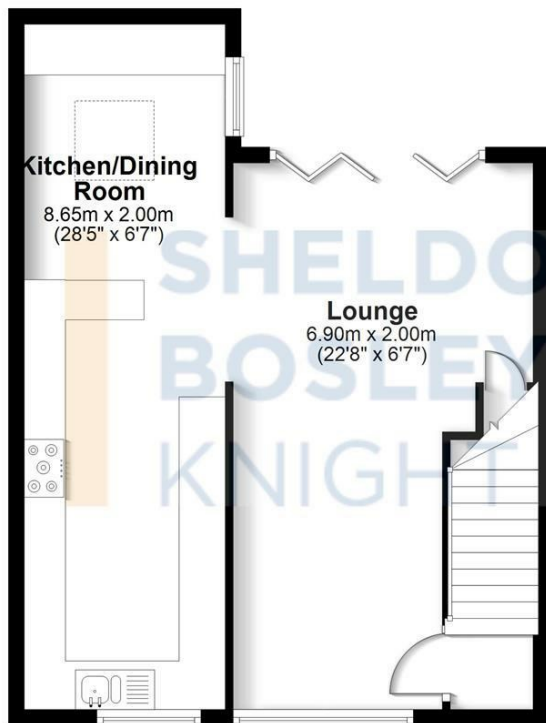

## First Floor

Approx. 42.9 sq. metres (461.8 sq. feet)

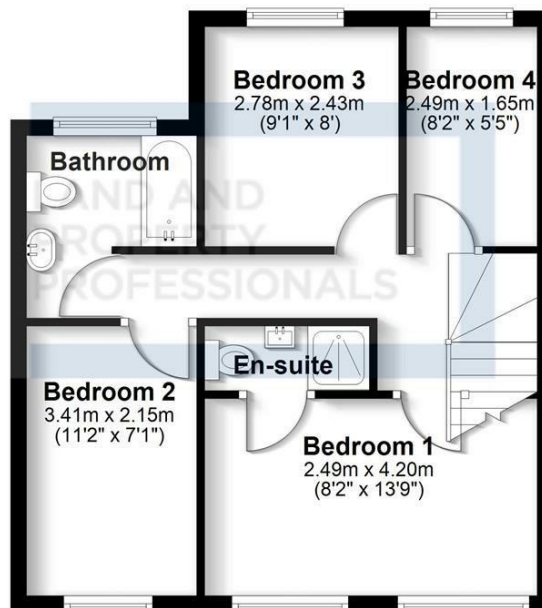

Total area: approx. 87.0 sq. metres (936.8 sq. feet)

All efforts have been made to ensure the measurements are accurate on this floor plan, however these are for guidance purposes only.  
Plan produced using PlanUp.



EPC Rating - B

Tenure - Freehold

Council Tax Band - B

Local Authority  
NBBC





We routinely refer clients to both our recommended legal firm and a panel of financial services providers. It is your decision whether you choose to deal with these companies. In making that decision, you should know that we receive a referral fee.

**SHELDON  
BOSLEY  
KNIGHT**

LAND AND  
PROPERTY  
PROFESSIONALS